

Legend
Work area

TCP IB 025 rev E
Vehicle cross over at
Bonville Station Road

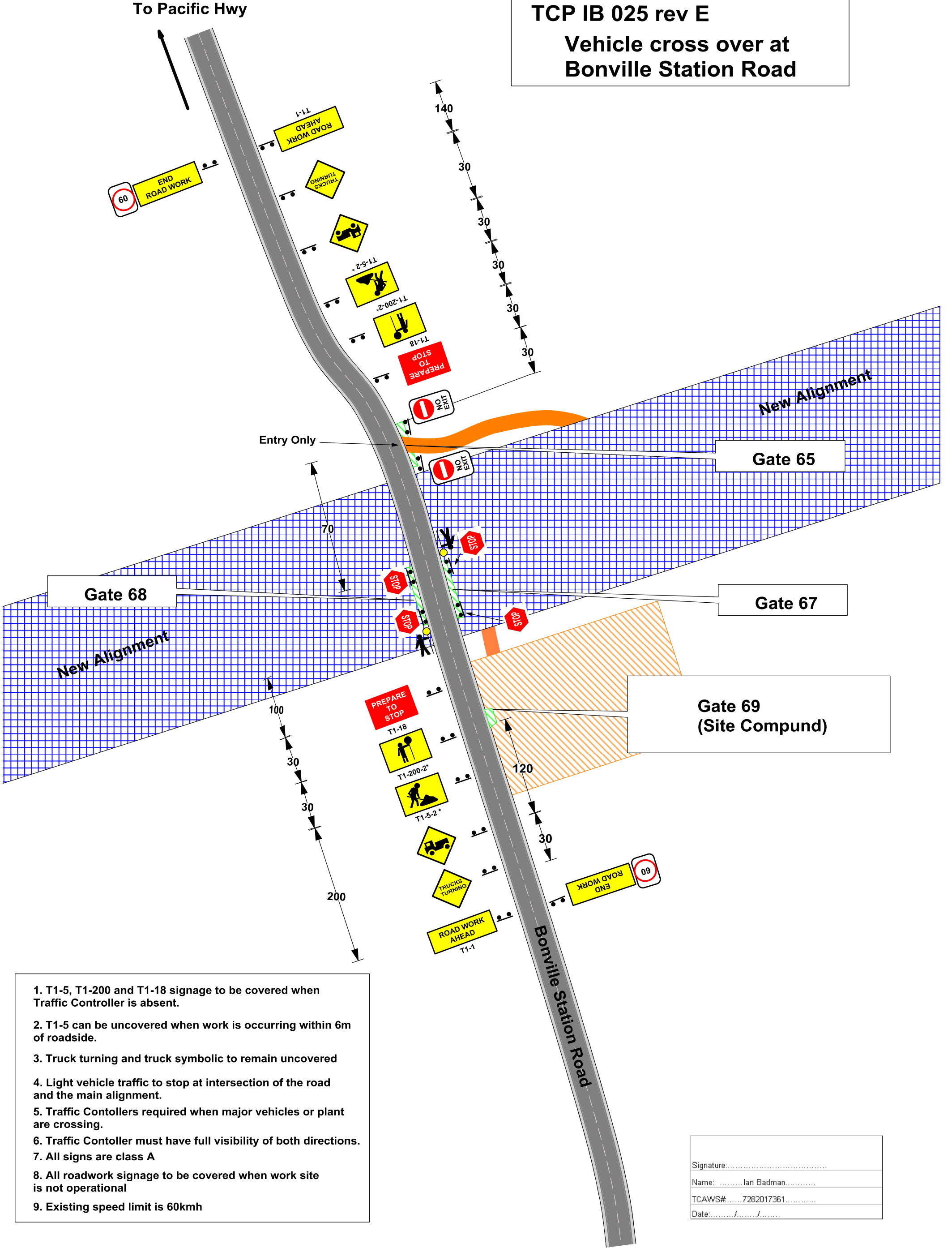

1. T1-5, T1-200 and T1-18 signage to be covered when Traffic Controller is absent.
2. T1-5 can be uncovered when work is occurring within 6m of roadside.
3. Truck turning and truck symbolic to remain uncovered
4. Light vehicle traffic to stop at intersection of the road and the main alignment.
5. Traffic Contollers required when major vehicles or plant are crossing.
6. Traffic Contoller must have full visibility of both directions.
7. All signs are class A
8. All roadwork signage to be covered when work site is not operational
9. Existing speed limit is 60kmh

Signature:.....
 Name: Ian Badman.....
 TCAWS#: 7282017361.....
 Date:...../...../.....